72611 Thin Wall Gamma Detector

GENERAL SPECIFICATIONS

Gas filling	Ne +Halogen
Cathode material	446 Stainless Steel
Maximum length (inch/mm)	1.96/49.8
Effective length (inch/mm)	0.25/6.4
Maximum diameter (inch/mm)	0.34/8.7
Connector	Grid Cap
Operating temperature range °C	-40 to +75
Effective diameter (inch/mm)	0.25/6.4

ELECTRICAL SPECIFICATIONS

Recommended anode resistor (meg ohm)	1
Maximum starting voltage (volts)	800
Recommended operating voltage (volts)	900
Operating voltage range (volts)	850 - 1000
Maximum plateau slope (%/100 volts)	20
Minimum dead time (micro sec)	45
Gamma sensitivity Co60 (cps/mr/hr)	3.5
Tube capacitance (pf)	3
Weight (grams)	10
Maximum background shielded 50mm Pb + 3mm Al (cpm)	10

WALL SPECIFICATIONS

Areal density (mg/cm ²)	400
Thickness (inch/mm)	0.02/0.51

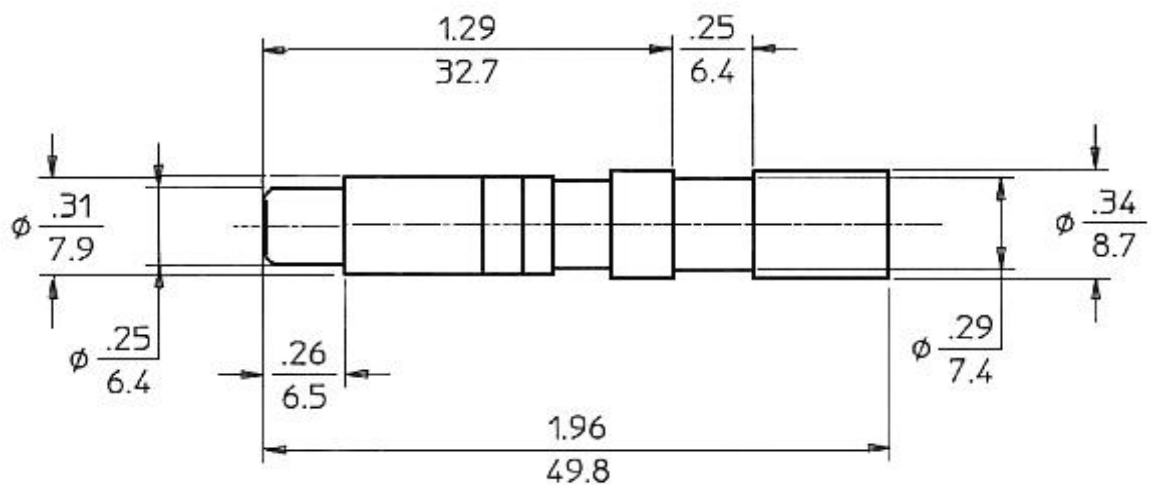

GAMMA SENSITIVITY

TUBE TYPE - 72611

